



Hymans Robertson London

The summer of 2006 has been characterised by **haa design's** increasing involvement with the education sector. The key issues of flexibility and rapid change, fuelled by advances in information technology follow on naturally from what **haa design** has experienced within the office sector. Not only does the use of space have to be thought of as something dynamic but, as technological issues are overcome, so do psychological issues rise to the fore. Thus it's no longer dispensing information which is the issue but digesting and developing it, understanding those different work 'modes' that learners require and understanding what will inspire them to want to learn in the first place.

WEST LOTHIAN COLLEGE

haa design has now had an involvement with the College lasting several years, starting with the design of its flexible learning 'HUB' and then moving on to a revamp of its Hairdressing, Beauty and Fitness department. Most recently we have undertaken a review of the entire campus to see how the somewhat formulaic spaces can be adapted to meet future learning needs. Hopefully, this will establish the foundations for a new 'development plan' and a process of change and improvement for the years to come.



West Lothian College Hairdressing



West Lothian College -Strategy

HYMANS ROBERTSON LONDON

haa design's London project for a major firm, actuaries, Hymans Robertson, is now complete. Conceived by **haa design** in Glasgow and implemented by their joint venture company AM interiors in London, it breaks new ground in thinking about open plan. Partly driven by the amorphous shape of the building at no.1 London Wall, the main working area is conceived of as a free flowing space punctuated by service 'pods', providing easy access to quiet or confidential space, storage, printing and the like. This is not in itself new but the way in which these 'pods' are divorced from the main building elements, more as glorified furniture items, provides a new way of thinking about fit-out and ongoing change throughout the life of the organisation.

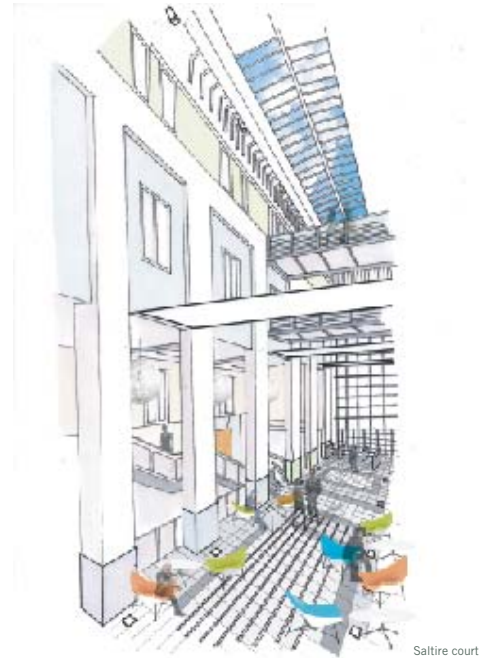

Saltire court

SALTIRE COURT

Plans for a major refurbishment of Edinburgh's iconic Saltire Court are now complete and the works out to tender. For those who do not know the building, it features an impressive atrium with views to the castle. **haa design's** solution has enhanced this cathedral-like space using dramatic lighting, furniture and finishes.



Hymans Robertson London

- INSIDE THIS ISSUE**
- WEST LOTHIAN COLLEGE
 - HYMANS ROBERTSON - LONDON
 - SALTIRE COURT
 - TODD BAR
 - 150 ST VINCENT STREET
 - 46 GORDON STREET
 - SCRA HAMILTON
 - HALCROW EDINBURGH
 - GARVEY HOUSE
 - DUMBARTON ROAD
 - SCOTTISH ENTERPRISE TECHNOLOGY PARK
 - WHYTE AND MACKAY
 - BEAM GLOBAL
 - ST ALOYSIUS COLLEGE
 - BANFF & BUCHAN COLLEGE
 - LTS & SQA

architecture
interiors
consultancy

haadesign

news



Todd Bar



150 St Vincent Street



46 Gordon Street



SCRA Hamilton

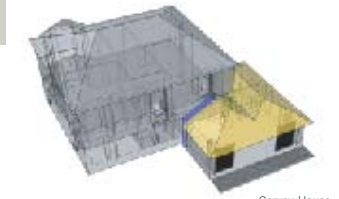

Garvey House

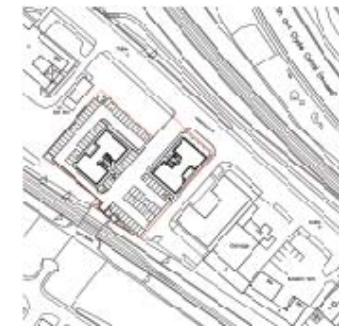

Dumbarton Road

TODD BAR

This Strathclyde University student bar required to be softened, made more intimate and updated. haa design's colourful solution incorporates variety and interest, taking into account potential student wear and tear.

150 ST VINCENT STREET

Working with Lambert Smith Hampton on behalf of St Martin's Property Co. haa design have developed proposals for updating the entrance and reception of this well known Glasgow landmark.

46 GORDON STREET

Working with CBRE on behalf of the landlord, haa have made applications for subdivision and, working separately with one of the tenants, Riddel Thoms, haa are developing proposals for general refurbishment.

SCRA HAMILTON

Work is already well advanced with haa design's second project for the 'Children's Reporter'. This developer-led new build project incorporates the same principles of workable open plan for the reporters and a new and more accessible image for the public.

HALCROW EDINBURGH

Halcrow's Edinburgh office is expanding dramatically like the rest of the group. Working within the constraints of an existing building, a mish mash of furniture and user groups, each with different requirements, haa design have been developing a strategy to optimise the utilisation of space while maintaining a pleasant environment that is conducive to efficient working.

GARVEY HOUSE

haa design are developing proposals for that ultimate family room we all long for, opening dramatically into the garden, where everything is relaxed but remains clean and neat and tidy. The planners approved it in a one-er! Now working on building control and affordable builders' prices.

PRIVATE DEVELOPER

A private developer has asked haa design to develop designs for an approx 18,000ft² new-build office, part of which they will occupy themselves. With work due to start on site early in the new year, the race is on to obtain planning and produce something which is simple and practical but representing the quality and style that the developer stands for.

DUMBARTON ROAD

This new build speculative office project for Speyroc is now on site with completion of phase 1 planned for the summer of 2007.

BEAM GLOBAL

haa design have been working with Beam Global's Glasgow office as they go through a period of growth and change following their acquisition of part of Allied Domecq.

SETP

This ongoing project, also for Speyroc, is due for completion by Christmas. The scaffolding in the atrium is now down, giving the chance for this key sustainable feature to be viewed for the first time. The outside will only come together with the addition of final cladding, external louvres etc, but the verdict is already that this simple but effective building sits well on its site.

SETP



WHYTE AND MACKAY

We have reported previously on this major fit-out but pictures are only now available which show how its branding and internal fitments come together to create a radical new image.



Whyte & Mackay

BANFF & BUCHAN COLLEGE

haa design's involvement with B&B College continues with the slow process of condition surveys and space budgets, all necessary to lay the foundation stones for a successful application to the Funding Council. Initial ideas for how the college might be transformed have been enthusiastically received, but now the real homework begins.

SQA/LTS

The linked fit-outs of Glasgow's Optima Building are already well used and being thoroughly tested. To try and capture something of the design process and the way designers' proposals do or do not come up to users' expectations, haa design are currently producing a video of the project(s), complete with management and staff unexpurgated comments.



Scottish Qualifications Authority



Learning Teaching Scotland



haa design's Berlin trip

In mid September the office closed down for a four day trip to Berlin. Like our 'discussion lunches', these enjoyable occasions are conceived of as 'social but with a purpose'. So, yes, beer was drunk and there were some over-excited midnight sessions on the giant see-saws in the Haftenplatz, but a great deal of serious walking, talking and looking took place also. These 'jollies', beloved of design firms, form an important part of both the social and professional dynamic of such offices. Buildings seen and places sat in become essential common reference points for later discussion. It is for this reason also that we try, where possible, to visit buildings and places with our clients at the start of any new job.

QUICKFIRE NEWS

New projects for West Lothian College & St Aloysius College

Video of SQA/LTS

4 day trip to Berlin